

**DATA SHEET**

- Type.....E2-ASNA 132Mb-6
- Reference standard.....IEC 60034-1; 60034-30  
60079-0;  
60079-15
- Rated output..... 5.5 kW
- Rated stator voltage.....400V
- Stator current at 100% load ..... 10.8 [A]
- Number of poles.....6
- Rated speed.....955 rev/min
- Rated frequency.....50Hz
- Efficiency at 100%, 75%, 50% load.....87.0%, 86.4%, 84.4%
- Power factor at 100% load.....0.82
- Break-down torque.....2.6 x Mn
- Locked rotor torque.....2.4 x Mn
- Locked rotor current.....6.5 x In
- Rotor inertia.....0.07128 kgm<sup>2</sup>
- Insulation class.....F
- Direction of rotation.....Both(CW&CCW)
- Protection degree.....≥IP55
- Mounting.....IM
- Cooling method.....IC 411
- Max. ambient temperature ..... + 40°C
- Altitude.....1000m
- Bearing type.....6308 2Z drive end  
6308 2Z non drive end
- Weight.....86Kg
- Outline drawing.....Page 2
- Vibration level :.....A (acc.IEC 60034-14 )
- Noise level .....acc.IEC 60034-9
- Cable entries..... 2xM32x1.5
- Climate execution .....N

**The overall and mounting dimensions  
IM 1001**

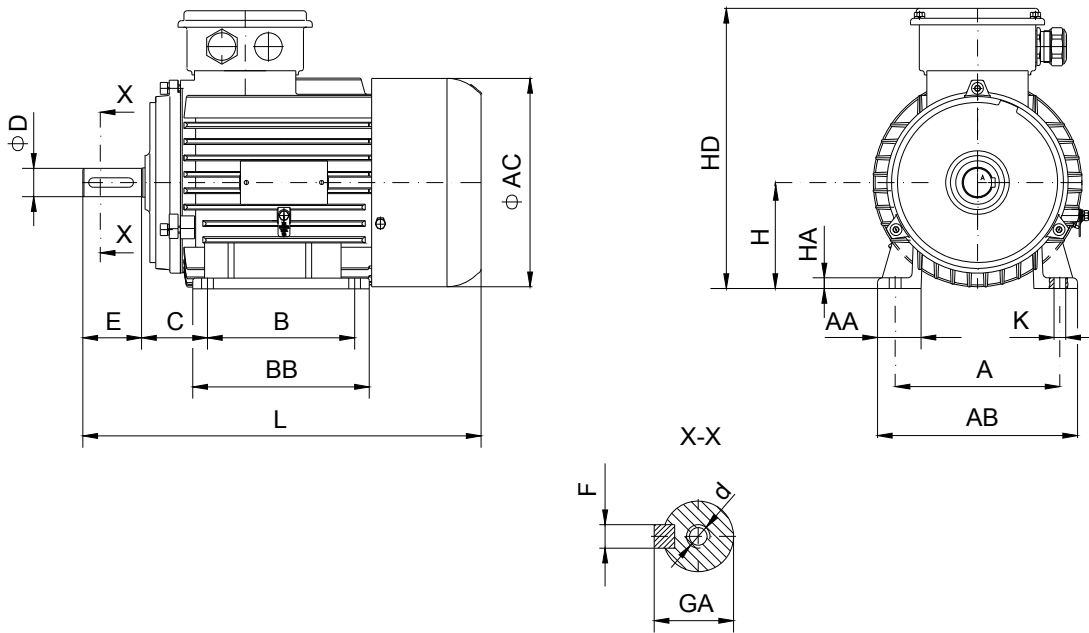

Frame size	Dimensions (mm)														HD max	AC	L max
	Foot mounting							Shaft extension									
	A	B	C	H	K	AA	AB	BB	HA	D	E	F	GA	d			
132M b-6	216	178	89	132	12	68	264	220	14	38k6	80	10h9	41	M12	400	263	653

**The overall and mounting dimensions  
IM 3001; IM 3011**

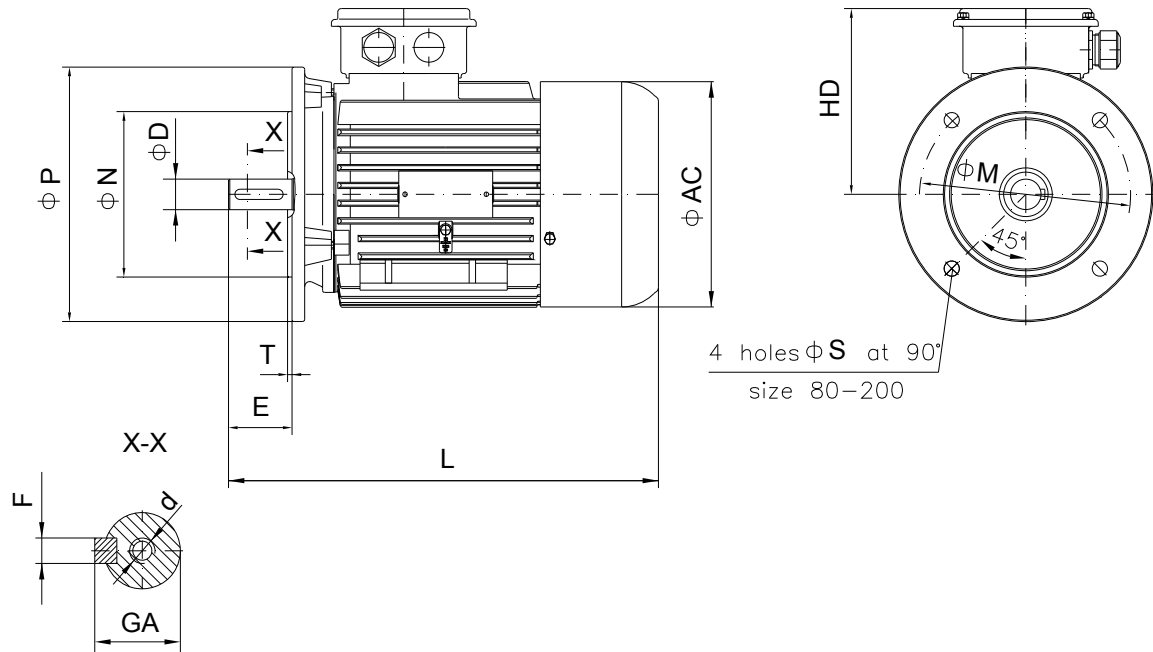

Frame size	Dimensions (mm)												
	Flange mounting (B5)					Shaft extension					HD max	AC	L max
N	M	P	S	T	D	E	F	GA	d				
132M b-6	230j6	265	300	14.5	4	38k6	80	10h9	41	M12	268	263	653

